

Powering Sydney's Future

POTTS HILL TO ALEXANDRIA TRANSMISSION CABLE PROJECT COMMUNITY NOTIFICATION

Update on construction at Edgeware Road, Newtown and Llewellyn Street, Marrickville

TransGrid is installing a new transmission cable from Potts Hill to Alexandria. The Powering Sydney's Future project will ensure a safe, reliable and affordable electricity supply for Sydney's CBD and surrounding areas. You can view a map of the cable route at www.transgrid.com.au/psf.

Thank you for your patience and cooperation over the June long weekend. This continuous work allowed us to complete the trenching on Edgeware Road between Victoria Road and Darley Street.

There is more work to do, and this letter provides an update on construction planned for Llewellyn Street and Edgeware Road over the next four weeks. This includes **work at night on Llewellyn Street**.

Llewellyn Street

In our letter delivered on 11 May 2021 we let you know that trenching on Llewellyn Street would be done during daytime hours. So far this week we have been able to progress some construction activities during the day, but some work has not been possible because we could not maintain a safe distance to traffic. We will now need to do part of our work on Llewellyn Street at night when traffic volumes are lower and we can close an extra traffic lane.

Night work on Llewellyn Street will start on Thursday 24 June and will take one to two weeks to complete. If we do this work on a night shift, we will not be working during the day in the same 24 hour period.

Trenching will be noisy and will include concrete cutting and concrete and rock hammering. We acknowledge this will cause disruption to local residents and that the work may affect individuals and families in different ways. We welcome you contacting us with any questions or concerns, or to seek assistance.

Following trenching we will be doing cable installation work on Llewellyn Street, between Juliett Street and Lynch Lane.

Edgeware Road

Trenching Edgeware Road between Darley Street and Lord Street will continue during day time hours. We will also permanently restore the traffic islands on Edgeware Road between Victoria Road and Darley Street.

When trenching on Edgeware Road is finished, we will start cable installation between Darley Street and Lord Street.

See below a summary of upcoming work – the estimated duration is subject to weather and ground conditions. Maps showing the traffic changes for each section of work are on the attached pages.

Street	Llewellyn Street		Edgeware Road	Edgeware Road
Between	Juliett Street and Edgeware Road		Victoria Road and Darley Street	Darley Street and Lord Street
Work hours	EITHER: Day work 7am to 6pm Monday to Sunday	OR: Night work 6pm to 6am Sunday to Thursday	Day work 7am to 6pm Monday to Friday	Day work 7am to 6pm Monday to Sunday
Activity	Trenching followed by cable installation	Trenching	Traffic island restoration	Trenching followed by cable installation
Start date	Trenching started	Thursday 24 June	Monday 28 June	Trenching started
Duration	Four weeks	One to two weeks	One week	Four weeks



Connect with us

Community Information Line: 1800 955 588

Email: psf@transgrid.com.au

Web: www.transgrid.com.au/psf

Postal address: PO Box A1000 Sydney South NSW 1235



Work activities for trenching, cable installation and traffic island restoration

- > Delivering plant and equipment to site, and installing site fencing.
- > Cutting the road surface with a concrete saw (prior to midnight where possible).
- > Concrete and rock hammering (prior to midnight where possible).
- > Tree trimming (as required) to create a safe distance from plant and equipment (directed by a qualified arborist).
- > Digging a trench about two metres wide using an excavator and installing conduits (pipes) in the trench.
- > Backfilling the trench and covering exposed areas with steel plates.
- > Excavating a pit for pulling the new cable into place and installing cable pulling equipment.
- > Installing small pits for communications equipment associated with the new cable in the road, footpath or nature strip.
- > Pulling cable through underground pipes at cable pulling pits and communications pits.
- > Using a pump/vacuum truck to remove water as required.
- > Permanently restoring the traffic islands on Edgeware Road between Victoria Road and Darley Street.
- > Temporarily restoring the road and any localised nature strip restoration work that may be necessary.

How will trenching and cable pulling activities affect you?

- > Trenching will be noisy at times, but we will make every effort to keep to a minimum and aim to complete **high impact noise activities** (concrete cutting and concrete / rock hammering) **before midnight** wherever possible.
- > Cable installation will generate some noise, including a generator operating at each cable installation location. We will make every effort to keep noise to a minimum.
- > **Traffic detours, temporary road closures** and **parking restrictions** will be in place for the safety of workers and road users. Please refer to the maps overleaf outlining the local traffic changes with each section of work.
- > There may be temporary closures of the footpath, but we will provide an alternative route for pedestrians.
- > Residents may experience short delays to access properties.
- > If we anticipate that your driveway access may be disrupted, we will inform you in advance and discuss arrangements.

What's next

We expect to be working on Edgeware Road and Llewellyn Street until July 2021 and will return at a later stage to test the new cable. We will continue to keep you advised of upcoming activities.

Once all work is complete in the area and the cable has been tested, we will permanently restore the road surface.

Contact us

If you have any questions or concerns, please contact the Powering Sydney's Future project team on 1800 955 588, or at psf@transgrid.com.au.

Register for local progress updates

Are you interested in email progress updates about work on Llewellyn Street and Edgeware Road?
To register email psf@transgrid.com.au with 'Email update' as the subject and include your name and street address.



For an interpreter please call **131 450** and ask them to call TransGrid on **1800 955 588**.
The interpreter will then assist you with translation.

Connect with us

Please visit our website: www.transgrid.com.au/psf or contact the Powering Sydney's Future project team:
Community Information Line: **1800 955 588** Email: psf@transgrid.com.au
Postal address: **PO Box A1000 Sydney South NSW 1235**

Traffic changes on Edgeware Road

The following traffic changes will be in place on Edgeware Road for the safety of workers and road users:

- > **Edgeware Road** will remain open to two-way traffic north of Darley Street.
- > **Edgeware Road** will be closed between Darley Street and Lord Street. Traffic going under Bedwin Road bridge will be diverted via Darley Street.
- > Traffic will only be able to turn left only from Lord Street onto Edgeware Road.
- > Parking restrictions will be in place on Edgeware Road 24/7 for the duration of the work.

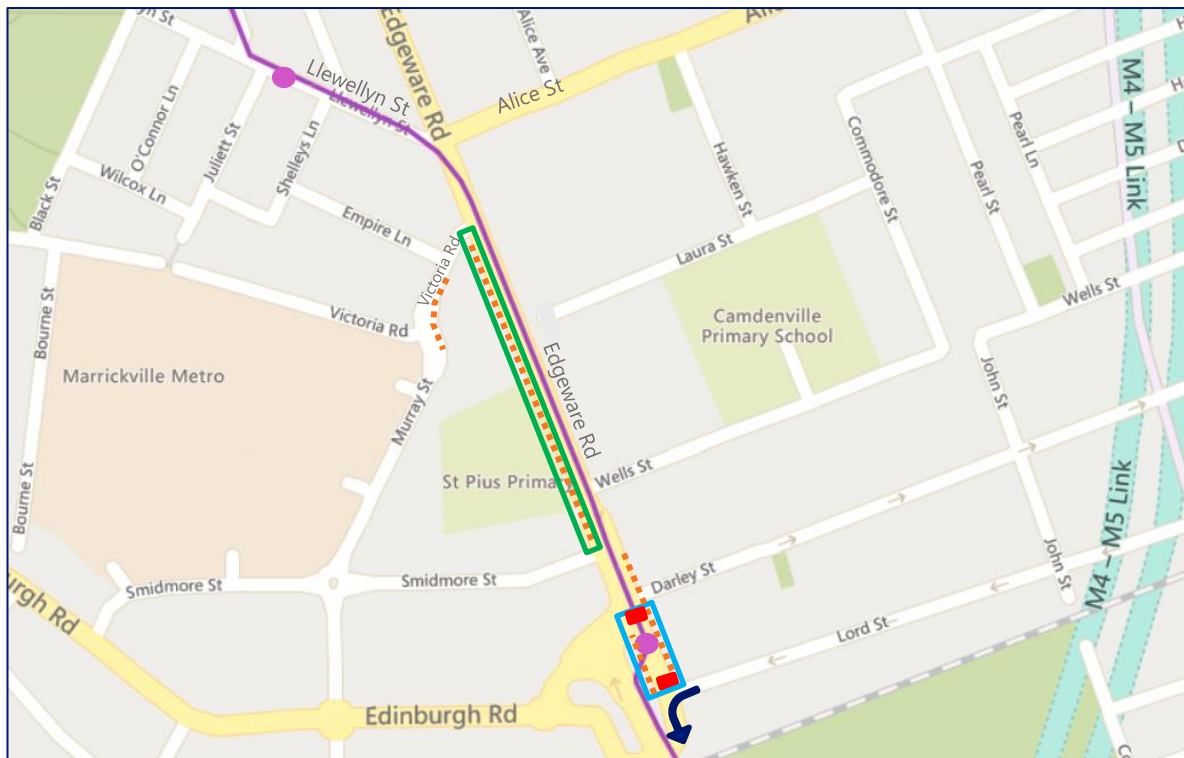

Legend

- Work area for trenching
- Work area for traffic island restoration
- Cable route
- Road closure and detour for non-residents
- On-street parking restrictions
- Cable pulling pits
- Joint bay
- Left only exit from Lord Street

Traffic changes on Llewellyn Street

The following traffic changes will be in place on Llewellyn Street 24/7 until trenching and cable installation work has been completed:

- > **Juliect Street, Lynch Lane and Shelleys Lane** will be temporarily closed to through traffic during the work.
- > All streets will remain open to local residents under traffic control as shown on the map below.
- > 'Left in, left out' arrangements will be in place for **Juliect Street and Shelleys Lane**.
- > Traffic on **Llewellyn Street** will be maintained under stop/slow traffic arrangements. Please allow extra time to travel through Llewellyn Street during the work.
- > Parking will be removed on Llewellyn Street and Juliect Street for the duration of work (24/7).
- > Traffic detours and traffic control will be in place for the safety of workers and road users.
- > Additional traffic changes in place at night only (7pm to 6am Sunday to Thursday): Traffic on **Edgeware Road, Llewellyn Street and Alice Street** will be maintained under stop/slow traffic arrangements. Please allow extra time to travel through this intersection during the work.

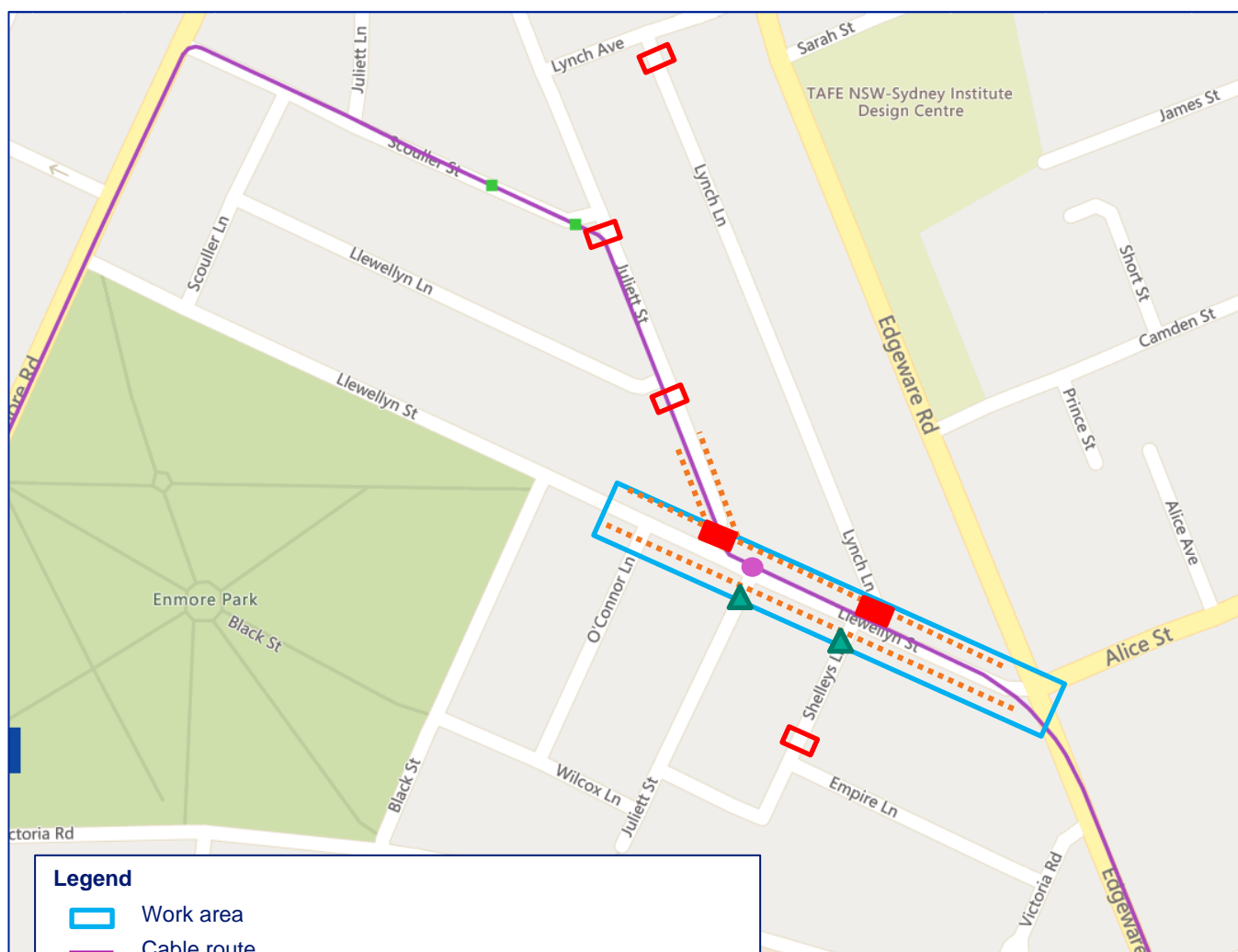

Legend

- Work area
- Cable route
- Road closure
- Resident access point
- On-street parking restrictions (24/7)
- Cable pulling pits
- Joint bays
- Access to/from Llewellyn Street will be left in, left out only