

Powering Sydney's Future

POTTS HILL TO ALEXANDRIA TRANSMISSION CABLE PROJECT COMMUNITY NOTIFICATION

Work update for Enmore Road and Scouller Street, Marrickville

TransGrid is installing a new underground electricity cable from Potts Hill to Alexandria. The Powering Sydney's Future project will help ensure a safe, reliable and affordable energy supply for Sydney's CBD and surrounding areas. You can view a map of the cable route at www.transgrid.com.au/psf.

Cable installation work at **Scouller Street, Marrickville** will get underway shortly as outlined in our letter delivered to you on 21 June. Once the cables are installed, we will join them together and carry out the remaining work activities in your area.

Remaining work

We expect to complete the work outlined below by **late August 2021**. Work may not be continuous during this period. Please note that some permanent road restoration work will be done at night.

- **Cable joining:** We will join sections of cables together at the joint bay marked purple on the map overleaf.
- **Excavation:** We will open up the previously constructed joint bay (marked orange on the map overleaf) and use CCTV to inspect the conduits we have already installed.
- **Testing:** Testing the new cable involves a crew lifting the lid off the previously installed communications pits and using hand tools to monitor the cable's performance.
- **Permanent restoration:** We will do concreting at the communications pits located in the grass verge.
- **Concrete road restoration at Enmore Road:** We will restore the road surface and carry out concreting at the intersection of Enmore Road and Scouller Street. Due to high daytime traffic volumes on Enmore Road, there will be a portion of this work done at night. **Night work will start from Monday 2 August** and is expected to take around **one week** to complete.

Please note that Scouller Street will be permanently restored later and you will be advised prior to this work starting.

Work hours

- > **Cable joining:** Work hours are **7am to 6pm Monday to Sunday**. Please note that joining work may extend beyond 6pm from time to time as steps in the process of joining cables must continue each day until they are complete.
- > **Excavation, testing and permanent restoration:** Work hours are **7am to 6pm Monday to Friday and 8am to 1pm on Saturdays**.
- > **Night work concrete road restoration:** Work hours are **6pm to 6am Sunday to Friday**.

How will the work affect you?

- > **At times, Scouller Street will be closed to through traffic.** Access for residents will be maintained.
- > Traffic on **Enmore Road** will be managed under a stop/slow traffic configuration.
- > The work will be noisy at times, but we will make every effort to keep noise to a minimum and aim to complete high impact noise activities before midnight wherever possible.
- > There will be a temporary loss of street parking. We will endeavour to maximise street parking where possible.
- > An alternative route will be provided if any diversions or closures of pedestrian pathways are required.
- > Residents and businesses may experience short delays to access properties.
- > If we anticipate that access will be disrupted for an extended period, we will inform you in advance.



Connect with us

Community Information Line: 1800 955 588

Email: psf@transgrid.com.au

Web: www.transgrid.com.au/psf

Postal address: PO Box A1000 Sydney South NSW 1235



Work activities

All activities will involve:

- > Installing temporary fencing and safety barriers.
- > Delivering plant and equipment to site.
- > Trimming trees to create a safe distance from plant and equipment (directed by a qualified arborist).
- > Using a pump/vacuum truck to remove water as required.

Excavation will also involve:

- > Excavating the ground using a road saw and excavator.
- > Covering any excavated sections of road with steel plates where required to maintain traffic flow.
- > Temporarily restoring the road surface to allow normal traffic flow.

Joining will also involve:

- > Setting up a temporary canopy with an air conditioning unit over the joint bay (about 10 metres long and three metres wide).
- > Placing a shipping container, rubbish skip and generator alongside the joint bay.
- > Technicians cutting, clamping together and permanently joining two ends of the cable under the canopy.
- > A security guard will remain onsite around the clock until work to join the cables is completed.

Concrete road restoration will also involve:

- > Preparing the road surface.
- > Placing new concrete for the road surface.
- > Line marking the road where required.

Location of work

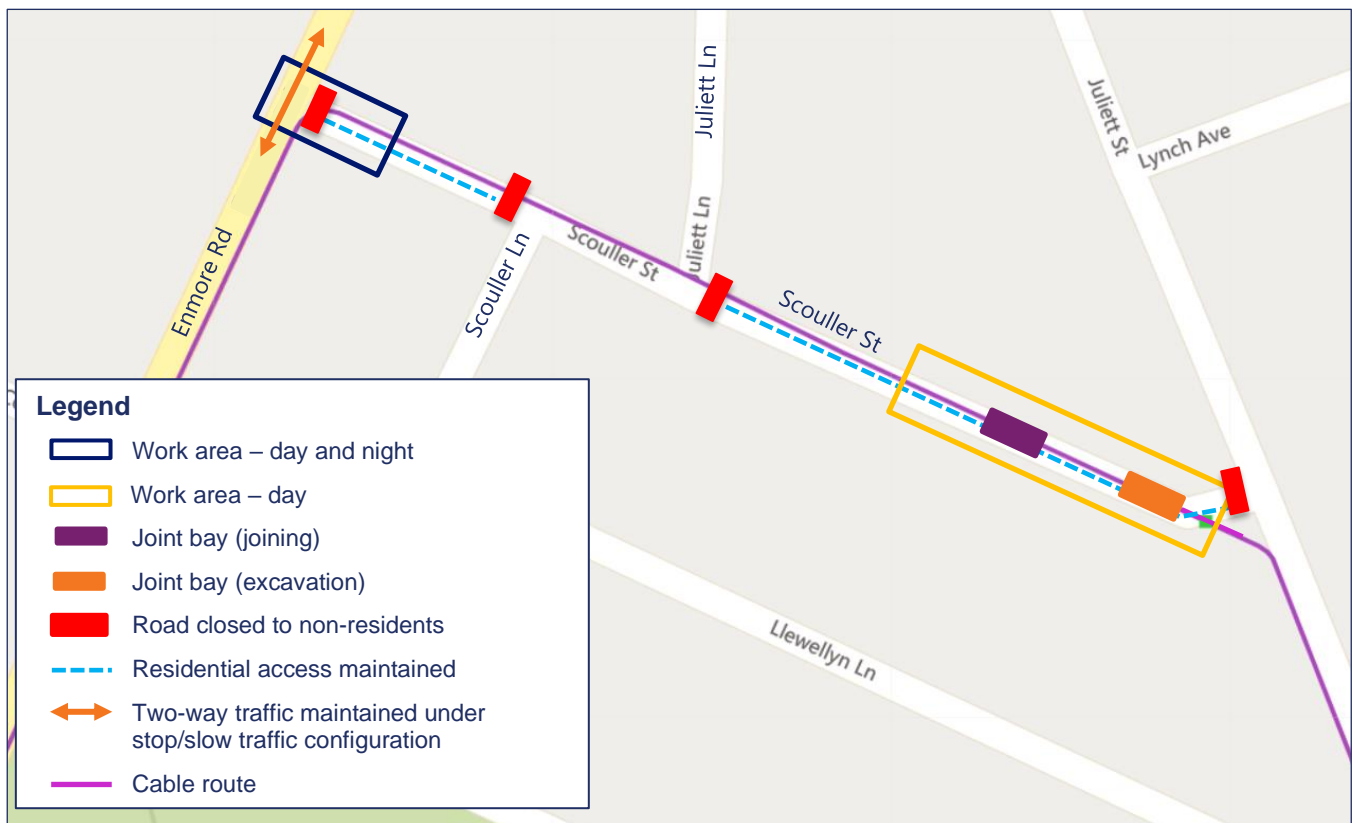

Contact us

If you have any questions or concerns, please contact the Powering Sydney's Future project team on 1800 955 588 or at psf@transgrid.com.au.



For an interpreter please call **131 450** and ask them to call TransGrid on **1800 955 588**. The interpreter will then assist you with translation.

**Connect
with us**

Please visit our website: www.transgrid.com.au/psf or contact the Powering Sydney's Future project team:
Community Information Line: **1800 955 588** Email: psf@transgrid.com.au
Postal address: **PO Box A1000 Sydney South NSW 1235**